

MGB 扭矩限制器
TYPE MGB TORQUE GUARD

MGB 轴-法兰连接
Shaft-to-ring connection

MGB型扭矩保护器是一种扭矩超载保护装置。它能在超载时通过限位开关或传感器控制立刻停止机器。通过扭矩数值指示器，能很容易的重新调整和设定扭矩。钢球的非对称安装允许只有一个复位位置。一经超载消失，它旋转一圈后自动恢复运行。它能保护你防止机器因过载受损而且可以避免昂贵的停工时间。

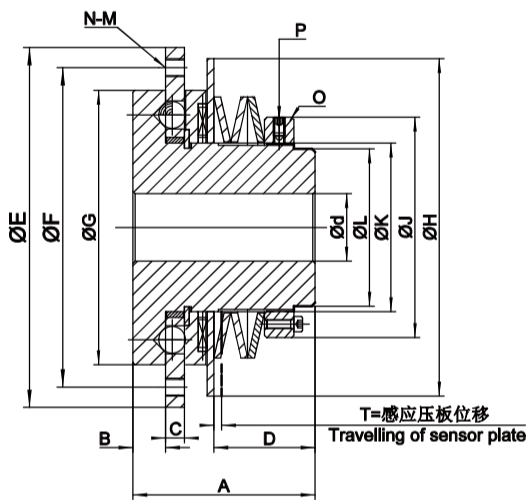

产品型号大小结构略有差异，咨询米什金获得3D, 2D图纸

MGB type Torque Guard is the ball detent type overload protection device. It can stop the machine immediately when overloaded by using noncontact micro switch. By the Torque meter and Indicator, desired torque can easily be set or adjusted. The non-symmetric arrangement of balls and pockets allow only one engagement position. Once the overload removed, it re-engages automatically by jogging a driving member. MGB Torque Guard can protect you from the machine damage and eliminate costly downtime.

MGB 型扭矩限制器规格参数

Specifications of Type MGB Torque Guard and Torque Guard Coupling

型号 TYPE MGB	扭矩范围 Torque Range (Nm)			惯性 (10 ³ kgm ²)	重量 (Kg)	极限转速 (r/min)
	X	L	M			
MGB08	0.294-1.470	0.784-2.156	1.176-2.940	0.0025	0.14	1200
MGB12	0.686-2.940	1.960-4.900	2.940-5.880	0.0065	0.24	1000
MGB16	1.470-4.900	2.940-7.840	5.880-11.76	0.018	0.44	900
MGB20	9.800-44	--	--	0.058	0.9	700
MGB30	20-54	54-167	--	0.2	2	500
MGB50	69-147	137-412	196-539	0.21	5.9	300
MGB70	294-1080	--	--	6.3	17	160
MGB90	441-1323	931-3136	--	33.8	37.5	120
MGB110	686-1960	1568-5096	--	91	69.6	100
MGB130	1176-3038	2646-7154	--	47	102	80

MGB型扭矩保护器的尺寸 Dimensions of Type MGB Torque Guard

型号 Model	A	B	C	D	E (h7)	F PCD	G	H	J	K	L	M	N	O 调节螺母 Adjust Nut	P 锁紧螺钉 Set Screw
MGB 08	39	6.5	5	20	40	34	26	33	30	15	—	M3	3	M15X1	M3X4
MGB 12	46	8	6	23.5	48	40	32	40	35	20	—	M4	3	M20X1	M4X6
MGB 16	55	8.5	8	27.7	58	50	39	48	45	25	—	M4	3	M25X1.5	M5X6
MGB 20	47	7.5	5.7	25	90	78	62	82	48	32	30	M5	4	M32X1.5	M5X6
MGB 30	60	9.5	7	33	113	100	82	106	65	45	43	M6	6	M45X1.5	M5X6
MGB 50	81	15	8.5	44.8	160	142	122	150	95	75	70	M8	6	M75X2	M5X10
MGB 70	110	15	12	68.5	220	200	170	205	157	110	106	M10	6	M110X2	M5X10
MGB 90	157	25	22	88.6	295	265	236	290	203	130	124	M12	8	M130X2	M10X20
MGB110	195	30	25	105	355	325	287	345	266	160	155	M16	6	M160X3	M12X20
MGB130	230	35	27	130	400	360	319	390	304	190	184	M16	8	M190X3	M16X30

订货描述 Order form:

规格与型号	扭矩范围	d-成品孔径	A型国标键槽
Size/Type	Torque range (N.M)	Finish bore (H7)	Key way 6 (JS9)
MGB20	L	Y20	A6

MGB-C 扭矩限制器 
TYPE MGB-C TORQUE GUARD
 MGB-C 轴-轴连接 
 ring-to-ring connection

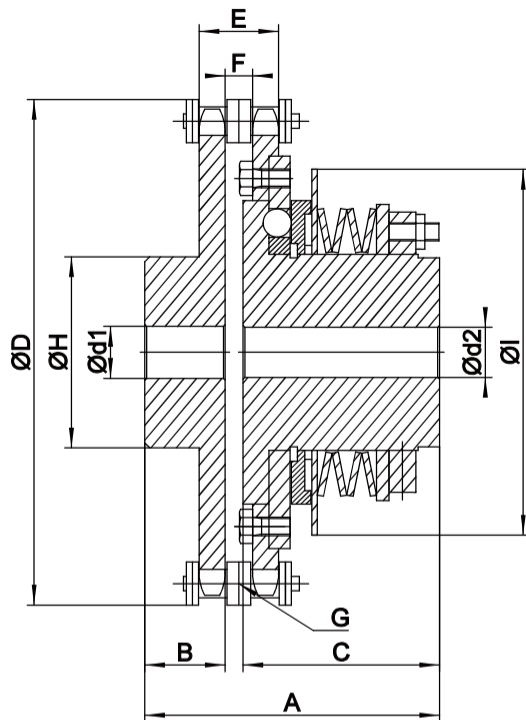

 MGB扭矩保护器最低扭矩数值设定在“0”点位置，产品出厂前请确认扭矩指示器被设定在“0”的位置，具体参数设定参照下面各曲线图。
 MGB Torque Guard are set at the "o" point (minimum torque value) for delivery. Confirm that the torque indicator is set at "0" when you receive the Torque Guard. (Refet to esch size in the graphs below)

 对于MGB70~130, 松紧三个六角形的锁紧螺母调整螺栓。(MGB70~130参照此法调节调整螺母)

For the MGB70 130, Jloosen the three hexagonal locknuts for adjusting bolts. (The adjusting nuts of MGB08 50 can be tuned as is.)

 从如下的“螺母旋合-扭矩关系图”，可知调整螺栓或螺母的旋合角度与扭矩数值变化的对应关系。根据预定值将扭矩设定在60°，然后在机器上安装并进行一次运行检验。均匀地调节以保证扭矩设定在最精准的位置。由于每个产品运行扭转矩不一定总是符合扭矩曲线图中的数值，因此只当做一个粗略的使用指南。

From the "Tighening Amount-Torque Correlation Chart" (below), find the adjusting nut's (blt) tightening angle equivalent to the predetermined trip torque. Set at 60 Toward the determined tightening value, then install to the machine and conduct a trip test. Gradually t"ghten and set at optimum trip torque.

Each products trip torque does not always correspond with the value listde in the " tightening amount-torque correla- tion chart " so usethem only as a rough guide.

 对于MGB20~50, 松紧一个锁紧螺丝来调整螺帽。对于MGB70~130, 使用一个六角形的螺帽锁住它。(MGB08~16调整螺帽表面覆尼龙套) For the MGB2050, tighten one lock screw for the adjusting nut.

For the MGB70 130, use a hexagonal nut to lock it. (The MGB08 16 adjusting nut is ocked with a nylon coating)

 不可将调整螺帽(螺栓)调整到比扭矩指示器最大值还大，这么做将会把它放入一个被锁住的位置。而且碟形弹簧也将失去发生弹性变形的活动余地。(MGB08~16使用螺旋弹簧)

do not turn the adjusting nut (bolt) more than the torque indicators maximum value. Doing so will put it in a locked position. And therewill be no leeway for the disk spring to bend. (MGB08 16 uses a coil spring.)

 具体的扭矩调节参数对照图请咨询米什金 米什金可提供3D 2D 图纸。

 MGB-C型扭矩限制器的尺寸Dimensions of Type MGB TorqueGuard

型号 Model	A	B	C	D	E	F	G	H	链轮规格 Sprocket size	质量 Mass (Kq)	转动惯量 Moment of Inertia ((X10Kg.fm2)	飞轮矩 G ² D (X10Kg.fm ²)
MGB 20-C	76	25	47	117.4	32.6	7.4	4	63	RS 40-26	2.5	0.313	1.25
MGB 30-C	93	28	60	146.7	40.5	9.7	5	73	RS 50-26	4.8	0.948	3.79
MGB 50-C	126	40	81	200.3	51.0	11.6	5	83	RS 60-30	12.2	4.43	17.7
MGB 70-C	165	45	110	283.2	64.8	15.3	10	107	RS 80-32	32.0	22.43	89.7
MGB 90-C	242	80	157	394.4	78.5	18.2	5	147	RS100-36	71.1	117.32	469.29
MGB110-C	303	100	195	473.4	99.2	21.9	8	157	RS120-36	130.5	314.15	1255.61
MGB130-C	365	120	230	534.2	127.3	29.1	15	197	RS160-30	2023	632.66	2530.63

 订货描述 Order form:

规格与型号	扭矩范围	d1-成品孔径	A型国标键槽	d2-成品孔径	A型国标键槽
Size/Type	Torque range (N.M)	Finish bore (H7)	Key way 6 (JS9)	Finish bore (H7)	Key way 6 (JS9)
MGB20	L	Y20	A6	Y20	A6